

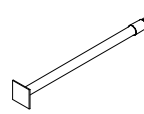

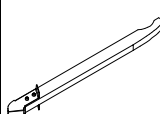

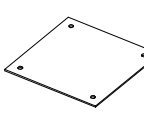

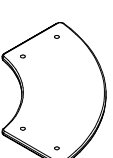

	① 907793 -216		PCS	② 009902		PCS
	1			4		
						
③ 009917		PCS	④ 009913		PCS	
1			4			
						
⑤ 708428		PCS	⑥ 909895		PCS	
1			4			
						
⑦ 909215		PCS	⑧ 900684		PCS	
4			4			
						
M16x280						
⑨ 900685		PCS	⑩ 909855		PCS	
4			16			
						
			M8x35			
			⑪ 909520		PCS	
			8			
						
			Ø30/17			
⑫ 909256		PCS	⑬ 980150		PCS	
66			24			
						
Ø16/8.4			M8			
			⑭ 906503		PCS	
			8			
						
			M8x120			
⑮ 980103		PCS	⑯ 903158		PCS	
8			8			
						
Ø4x50			M16			
			⑰ 909210		PCS	
			2			
						
			M8x40			
			⑱ 909851		PCS	
			16			
						
			M8x55			
⑲ 905097		PCS	⑳ 905083		PCS	
8			34			
						
M16			Ø32			
			㉑ 905112		PCS	
			34			
						
			Ø22			
			㉒ 702341		PCS	
			1			
						
			90x50			

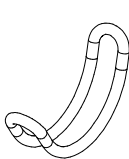
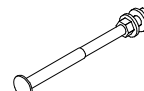
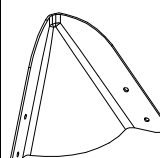
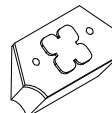
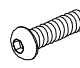
1: 25

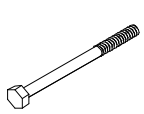
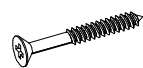
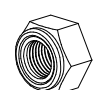
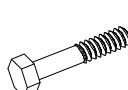
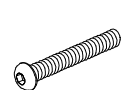

1: 75

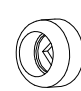
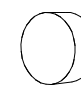
En Impact Area 35.3 m².
Max falling height 1000 mm.

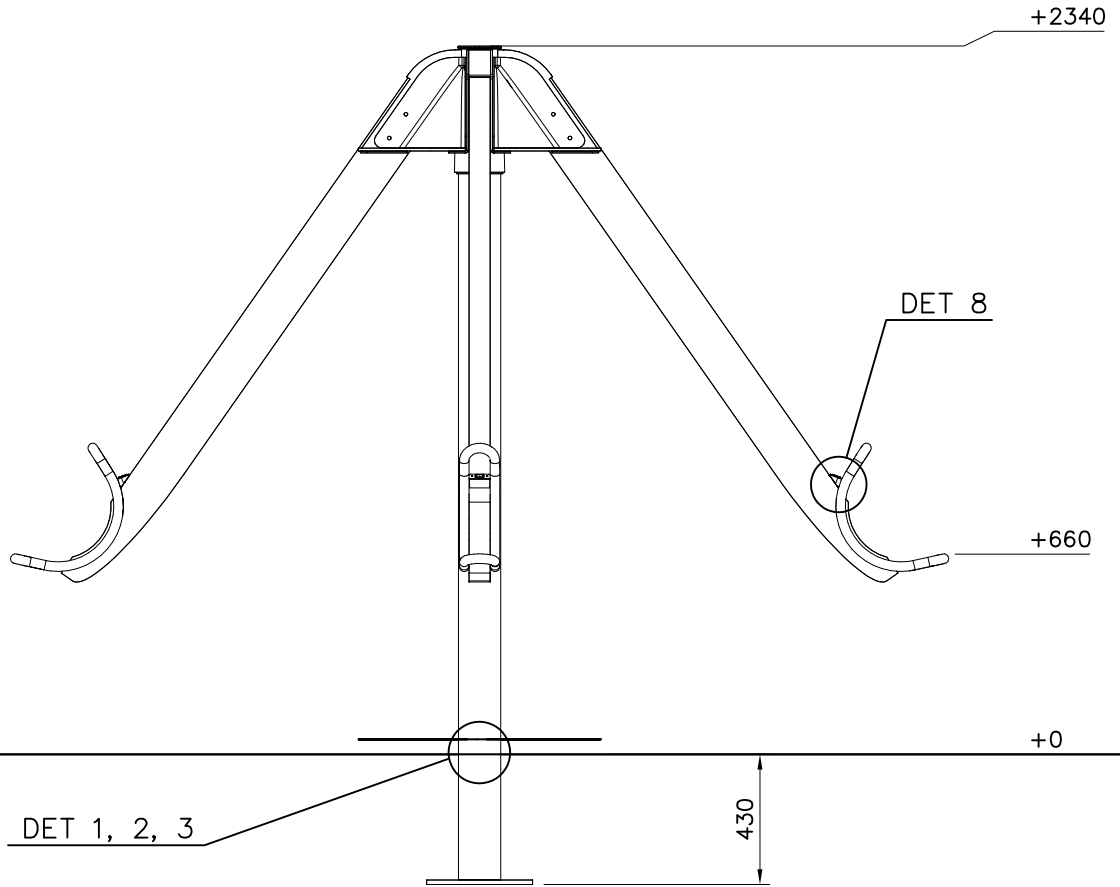
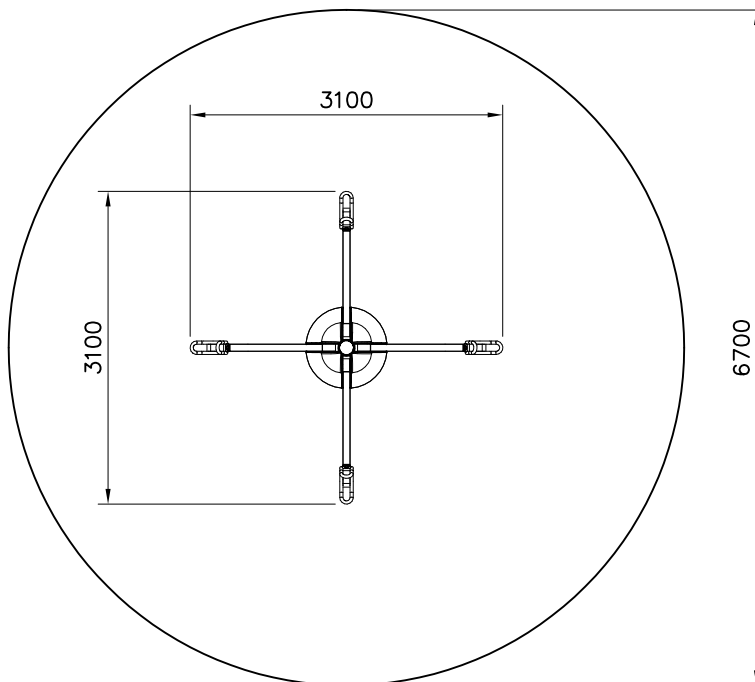

DET 1

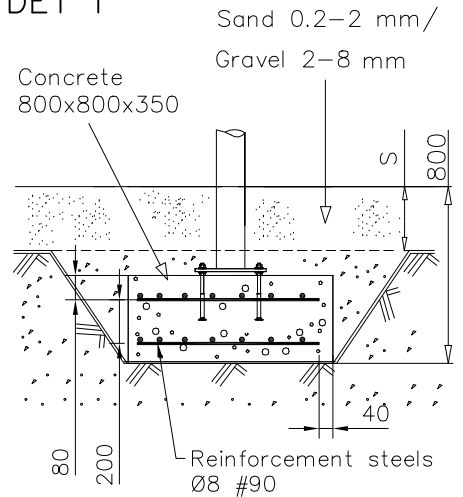

DET 2

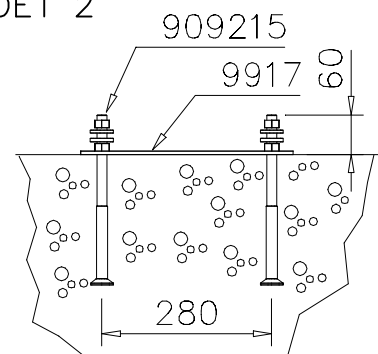

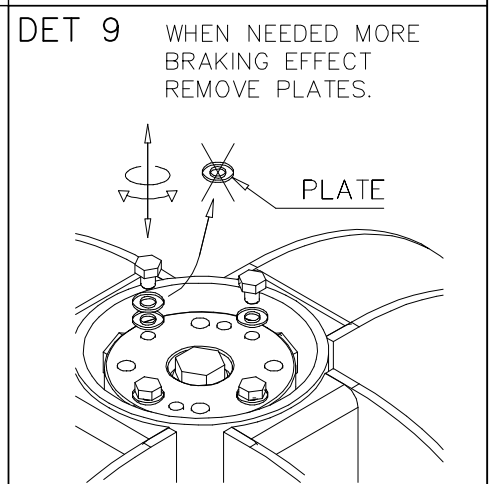
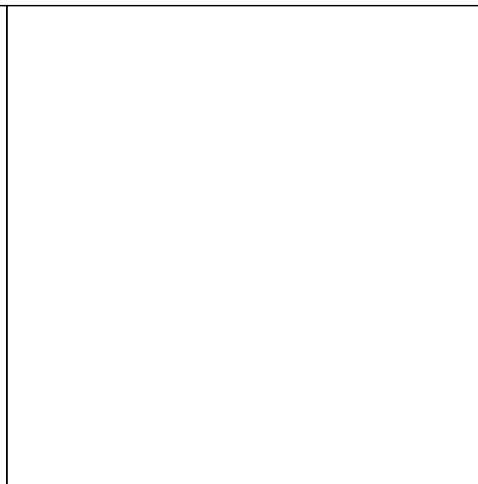
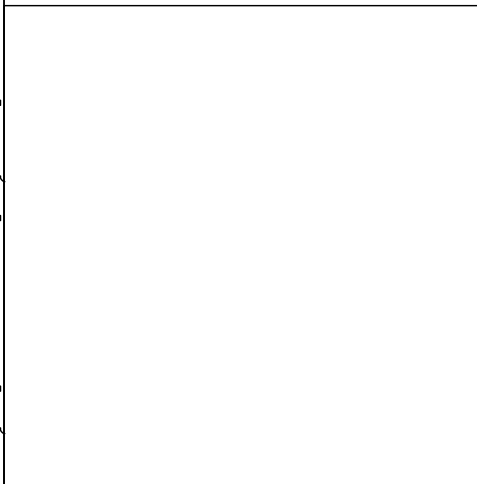
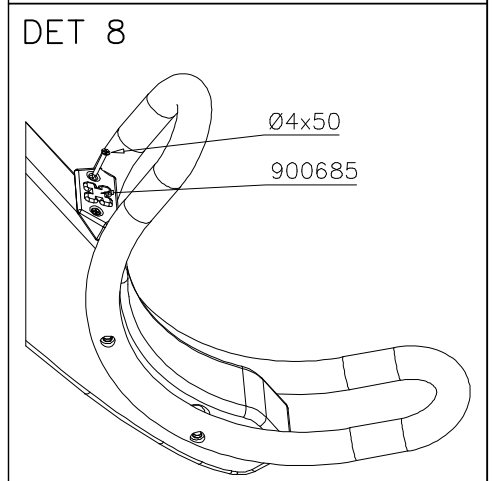
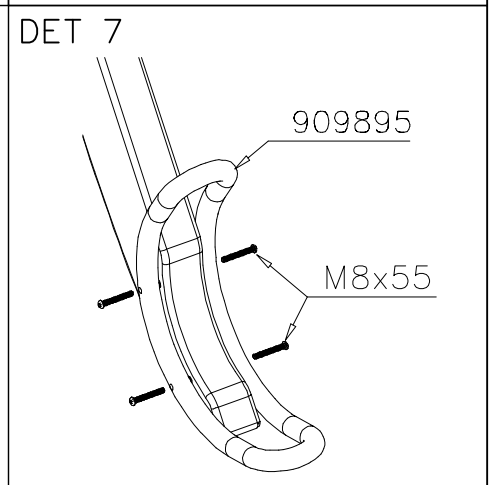
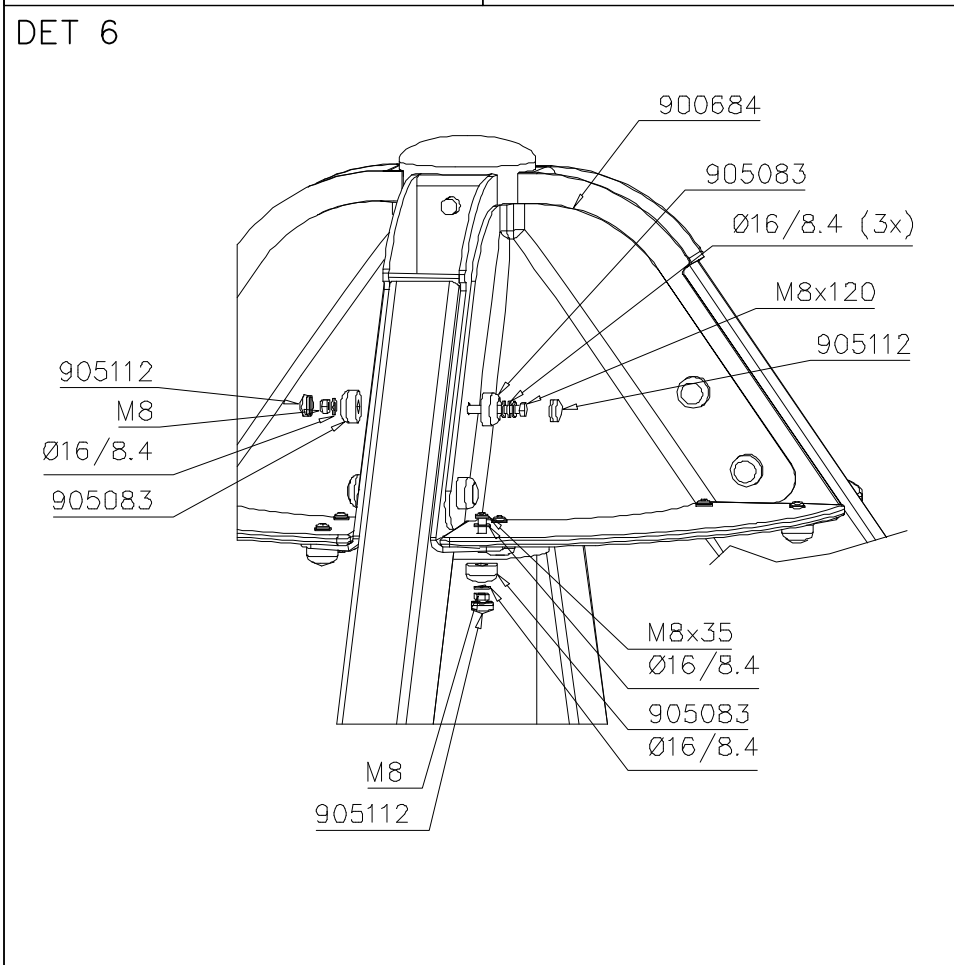
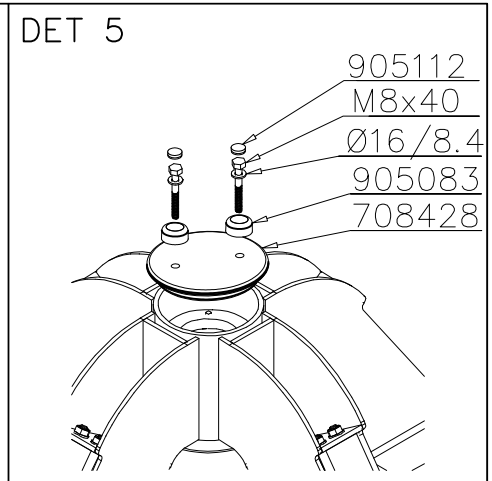
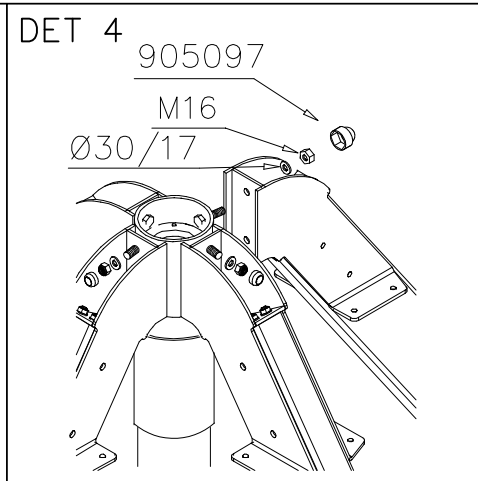
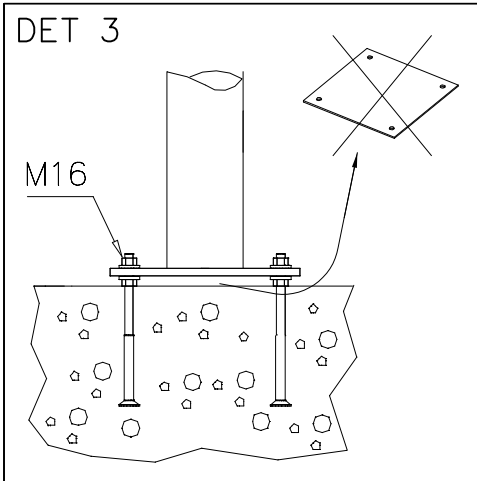

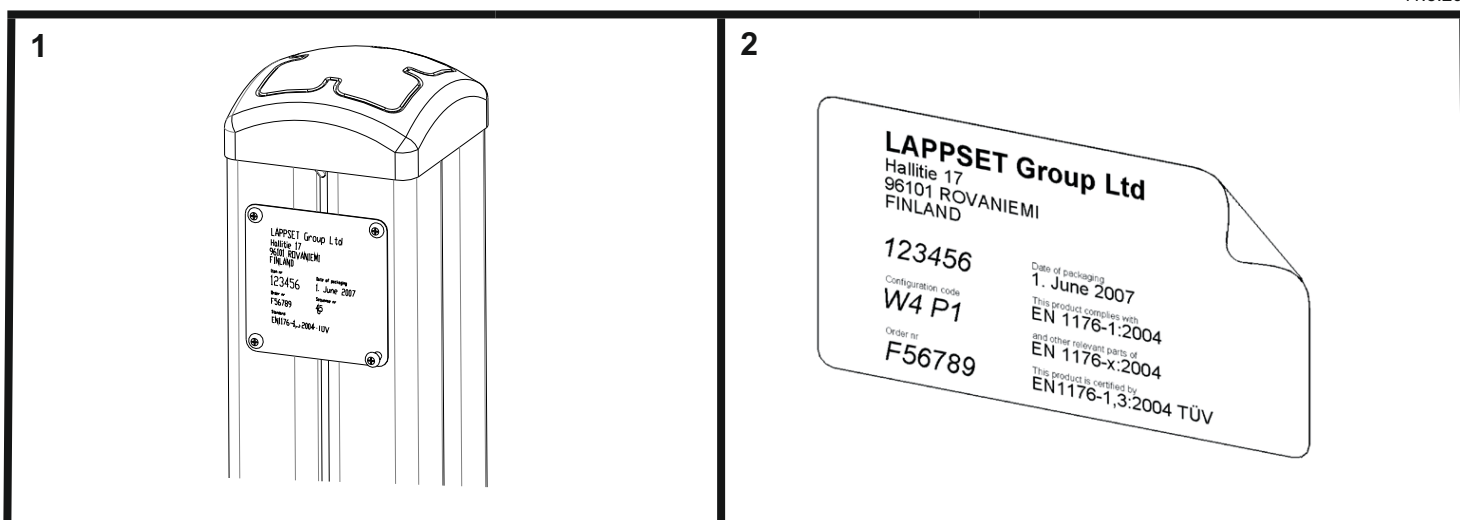

Tuotekyltti tulee tuotteen mukana yhdellä seuraavista tavoista:

1) Metallinen tuotekyltti ja kiinnitysruuvit

- Kiinnitä tuotekyltti ruuveilla tolppaan noin 2 metrin korkeuteen kuvan 2 mukaisesti.

2) Tuotekylttitarra

- Puhdista maalattu metalli- tai vaneripinta pölystä ja kosteudesta. Liimaa tarra kuvan 3 mukaisesti.
- Huom. Älä kiinnitä tarraa karheapintaiseen laminaattiin tai maalattuun puuhun.

Vår produktmärkning levereras på ett av följande sätt:

1) Produktskylt i metall

- Fäst skylten med de medföljande skruvarna

2) Självhäftande produktetikett

- Rengör den pulverlackerad metallytan eller laminatytans åttanblirfrifrånsmutsochfukt. Fäst etiketten enligt fig. 3.
- Obs! Fäst ej etiketten på detaljer med skrovlig yta eller på målat trä.

Product label is delivered by one of following ways:

1) Metal product label and screws

- Fasten the label with screws.

2) Label sticker

- Clean the painted metal or plywood surface from dirt and moisture. Fasten the sticker as shown in the figure 3.
- Note. Do not attach the sticker to rough surfaced laminate or painted wood.

La plaque d'informations produit est livrée sous l'une de ces 3 formes :

1) Plaque métallique et vis

- Fixez la plaque à l'aide des vis.

2) Etiquette autocollante

- Avant de coller l'étiquette, nettoyez le composant métallique peint ou la plaque de contreplaqué, de toute saleté. La surface doit être sèche (voir image 3).
- Attention, ne pas coller l'étiquette sur une surface lamellé-collée irrégulière ou sur du bois peint.

Die Auslieferung des Produktaufklebers erfolgt auf eine dieser Arten:

1) Produkt-Schild aus Metall incl. Schrauben

- Die Befestigung des Schildes erfolgt mittels der Schrauben.

2) Aufkleber

- Entfernen Sie zunächst Schmutz und Feuchtigkeit vom lackierten Metall bzw. von der Holzoberfläche und bringen Sie den Aufkleber wie im Bild oben rechts beschrieben auf den gesäuberten Untergrund auf.
- Beachten Sie: Bringen Sie den Aufkleber nicht auf raues laminiertes oder lackiertes Holz an.