









-  Bridges  
8
-  Climbing  
10
-  Play panels  
26
-  Roofs  
5
-  Slides  
3
-  Towers  
6

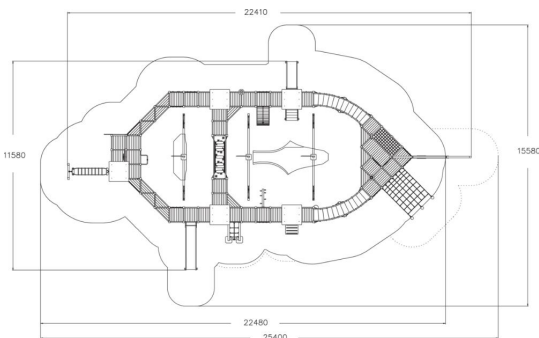
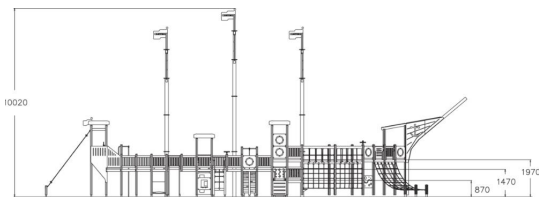

|                               |                  |
|-------------------------------|------------------|
| User age                      | 3+               |
| Number of users               | 100              |
| Product length, mm            | 22410            |
| Product width, mm             | 11590            |
| Product height, mm            | 10020            |
| Impact area, m <sup>2</sup>   | 203              |
| Falling space, m <sup>2</sup> | 220              |
| Height required, mm           | 10020            |
| Max. free fall height, mm     | 2900             |
| Safety info                   | EN 1176-1, 3 TÜV |
| Installation time (for 1), H  | 96               |
| Foundation options            | Deep mounting    |